

D RUST PREVENTIVE TREATMENT

BODY SEALING ----- D - 1
APPLICATION ----- D - 1
UNDERCOATING ----- D - 6
APPLICATION ----- D - 6
RUST PREVENTIVE AGENT ----- D - 8
APPLICATION ----- D - 8
ANTI-CHIPPING PAINT----- D - 9
APPLICATION ----- D - 9

1 BODY SEALING

1-1 APPLICATION

1-1-1 INSTRUCTIONS FOR WORK

For the rust prevention and waterproofing, fill body sealer to the joint section of the body panel and panel's hemming section.

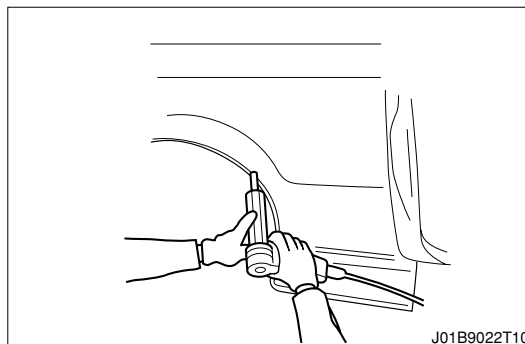

J01B9022T10

CAUTION

- Dampen a rag with non-residue solvent and use it to clean the sealer coating area.
- Dampen a rag with non-residue solvent and use it to clean any excess sealer.
- Remove spot sealer which adhered to the sealer applying section with thinner. Then, apply primer for rust prevention, and apply body sealer.

1-1-2 APPLICATION AREAS

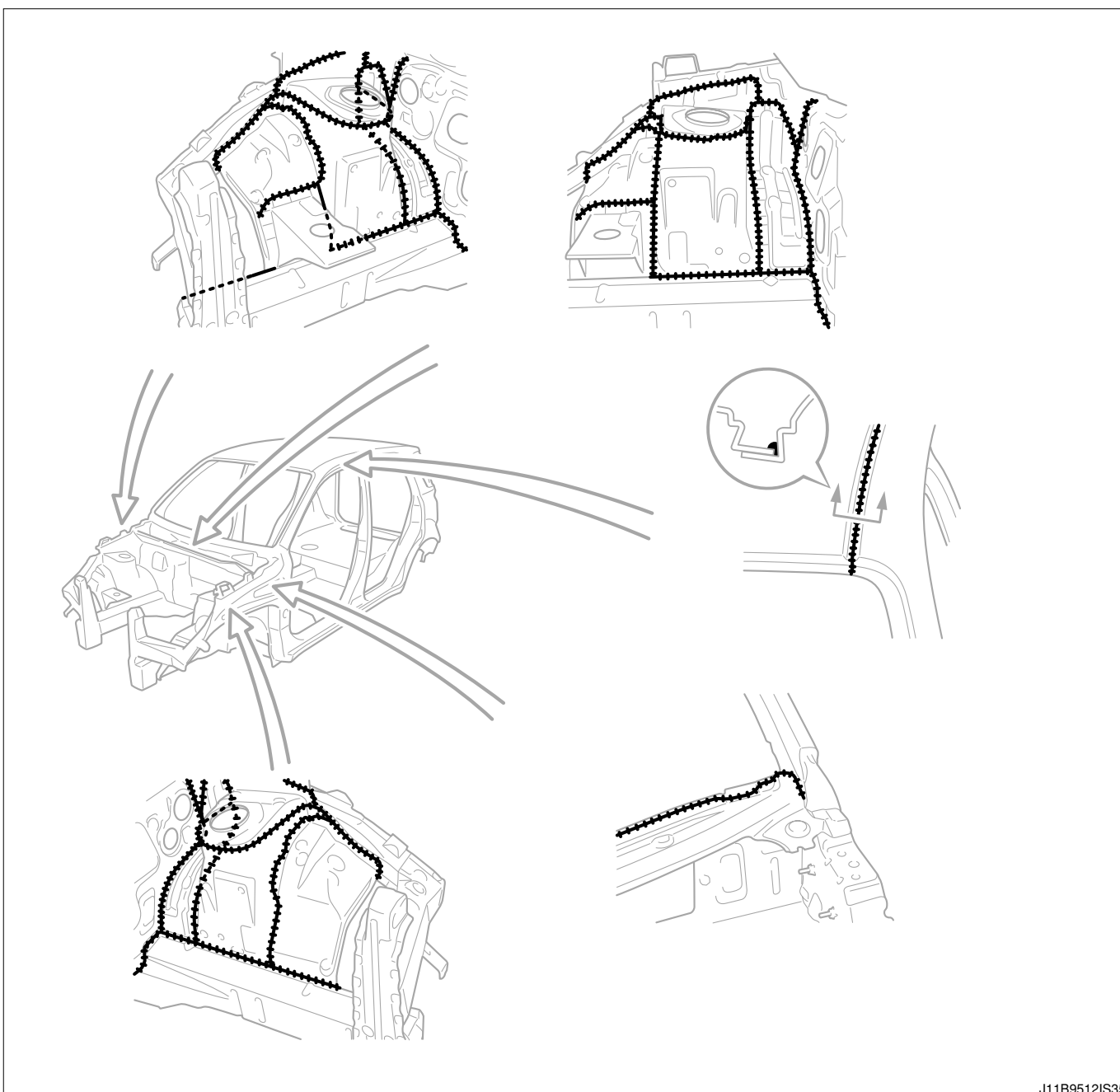

J11B9512IS35

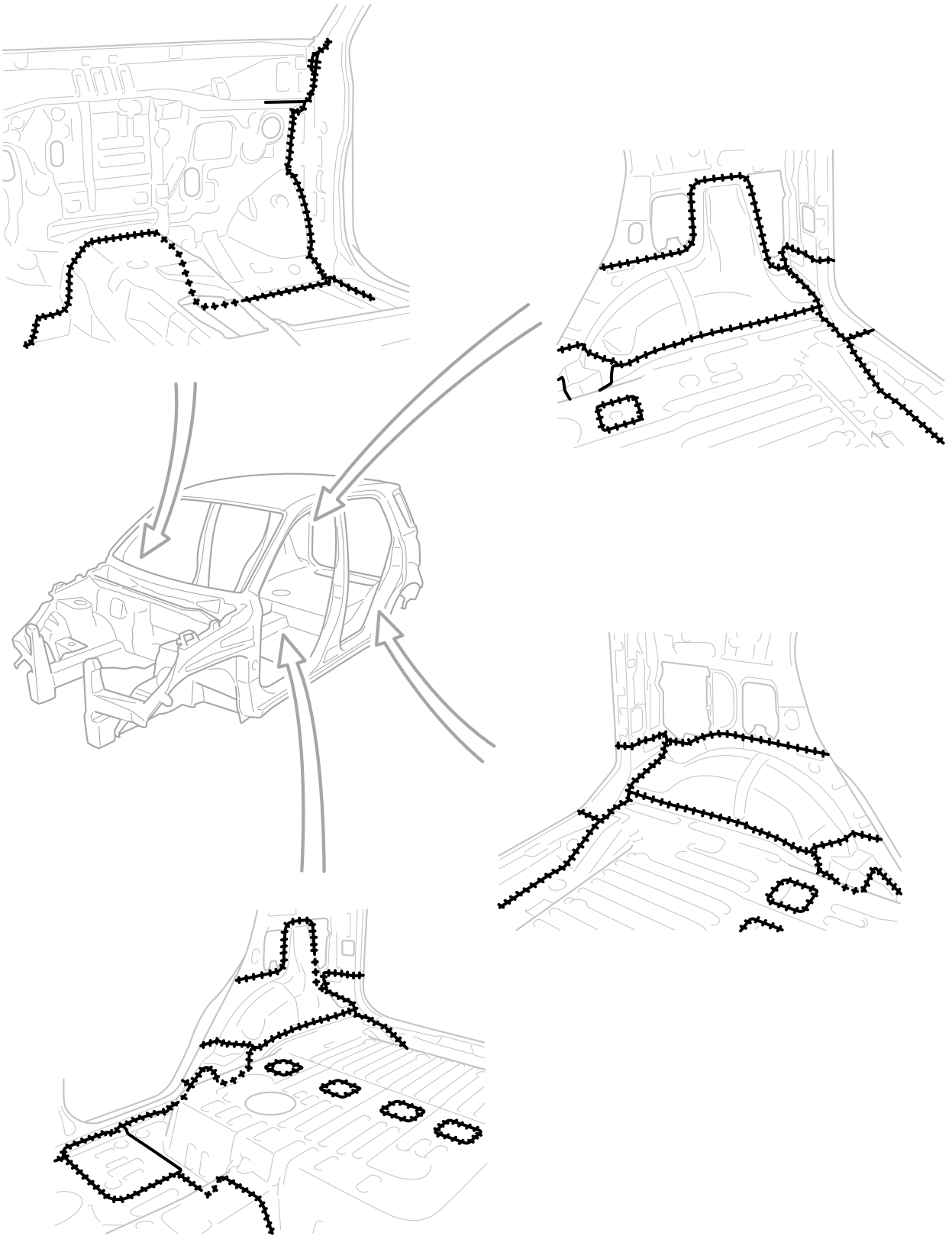

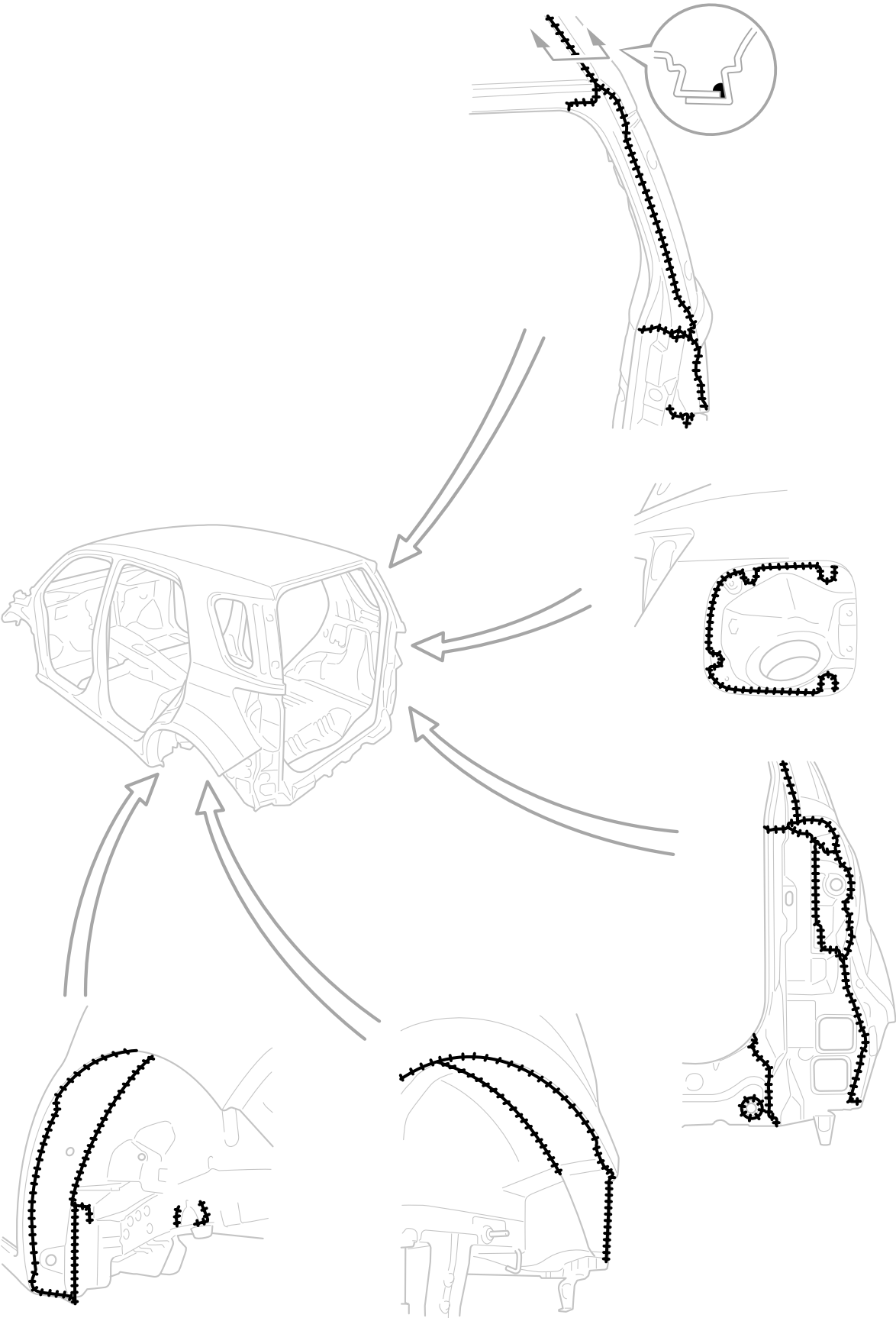

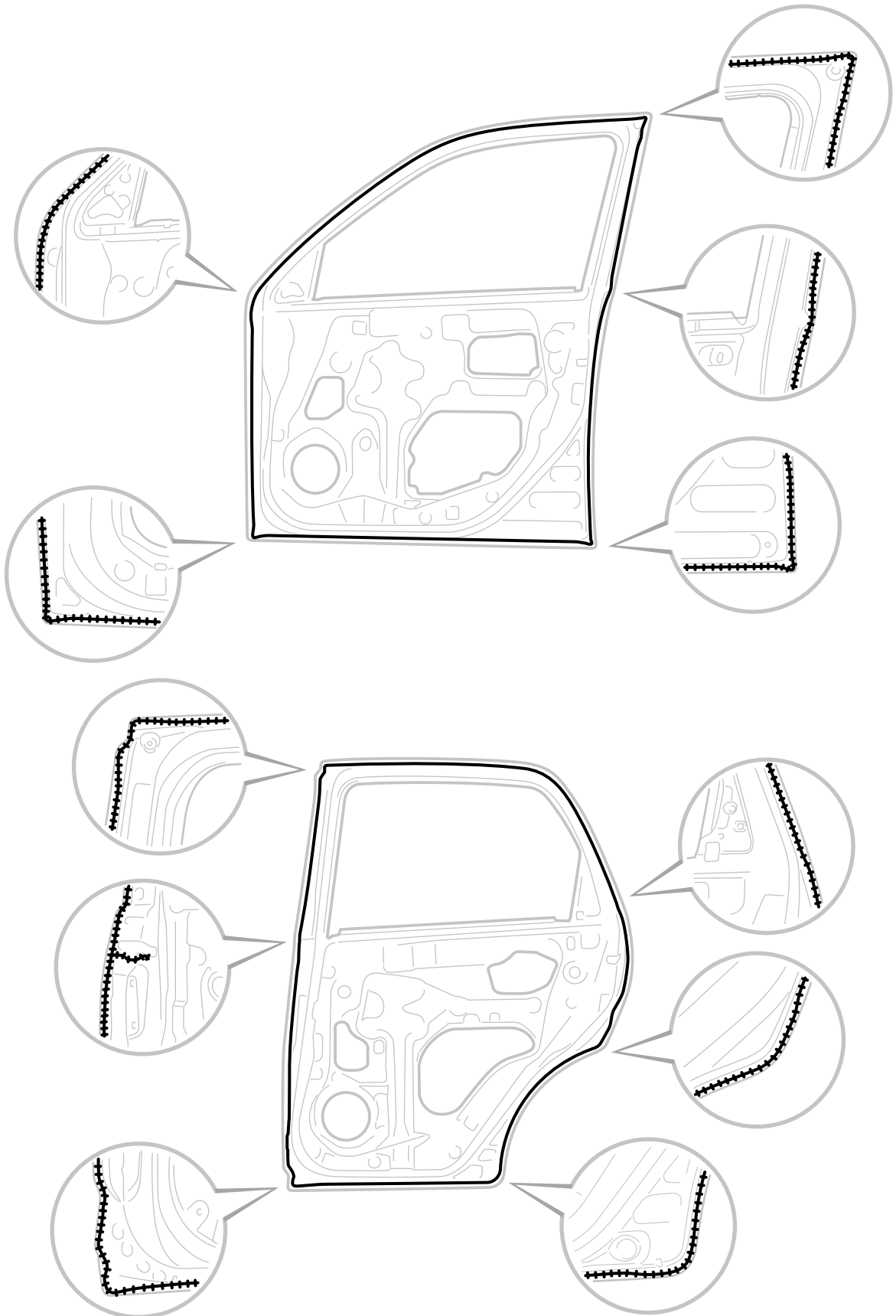

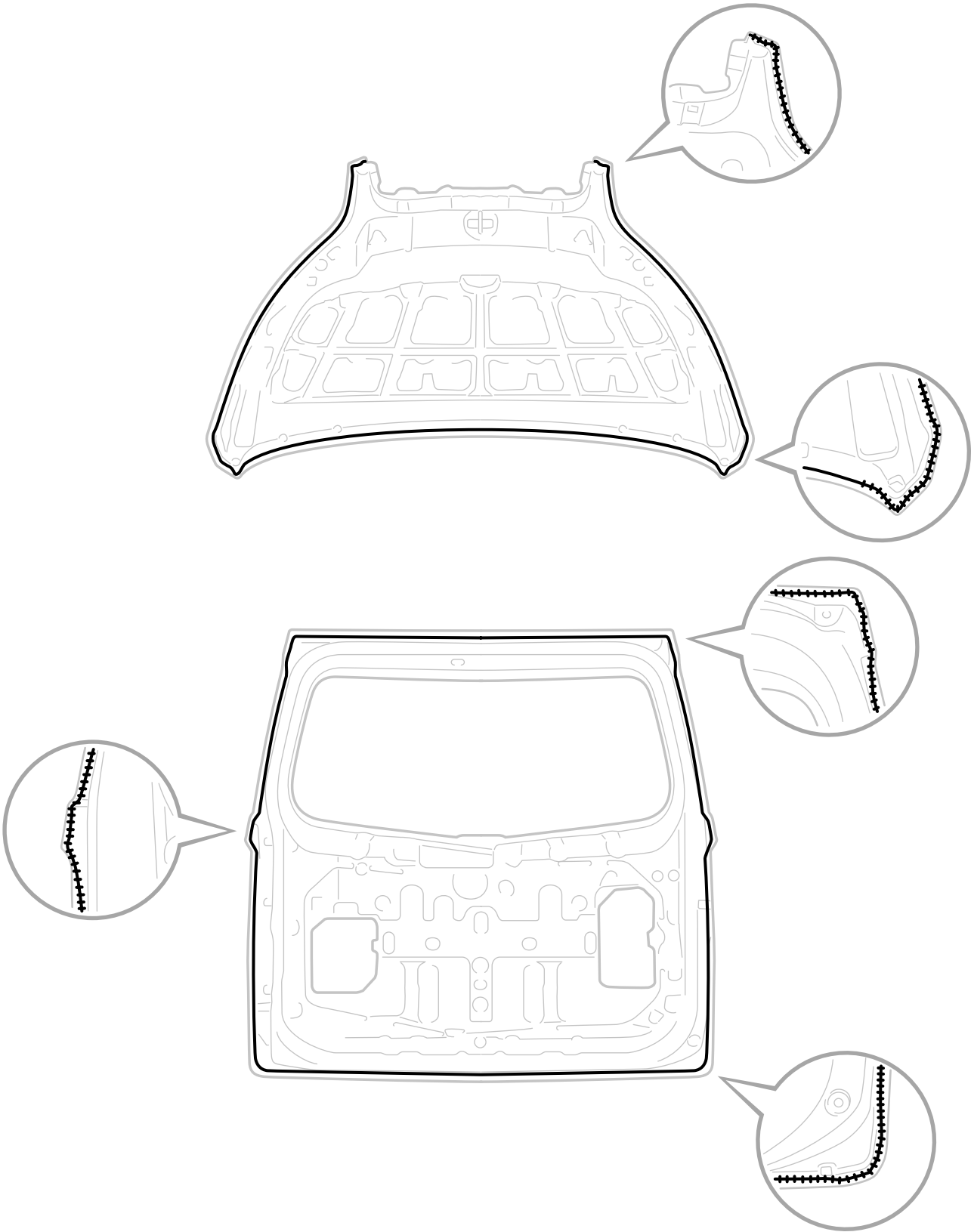

2 UNDERCOATING

2-1 APPLICATION

2-1-1 INSTRUCTIONS FOR WORK

For soundproof and rust prevention, apply the undercoat agent to the back side of the floor and the inside of the wheel house.

CAUTION

- Clean the sections to which the undercoat is applied, using a cloth dampened with white gasoline.
- Do not apply the undercoat to those sections where such application is not required; e.g. the muffler.
- If the back side of the floor has been welded, apply the undercoat for the purpose of rust prevention.
- Carefully close any clearance of a joint section between panels.

2-1-2 APPLICATION AREAS

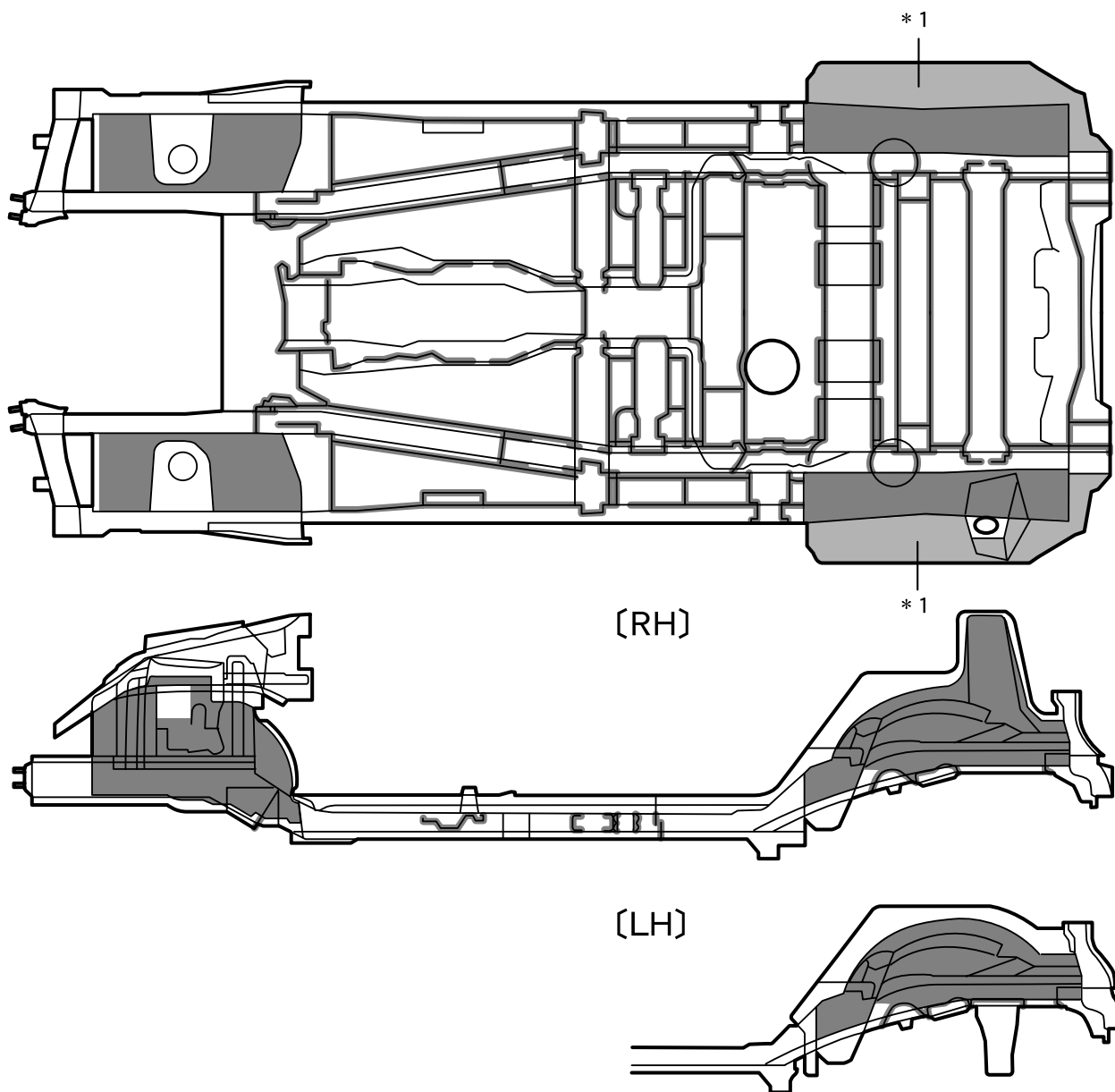

J11B9065IS40

*1: Make the coating film thickness inside the rear wheel house 2 mm.

3 RUST PREVENTIVE AGENT

3-1 APPLICATION

3-1-1 INSTRUCTIONS FOR WORK

Apply rust-preventive agent to the joint section of the body panel, the reverse side of the hemming section of the door and hood (the forward end of the bending section of the external sheet), and around the hinge.

CAUTION

- Dampen a rag with non-residue solvent and use it to clean any excess sealer.

3-1-2 APPLICATION AREAS

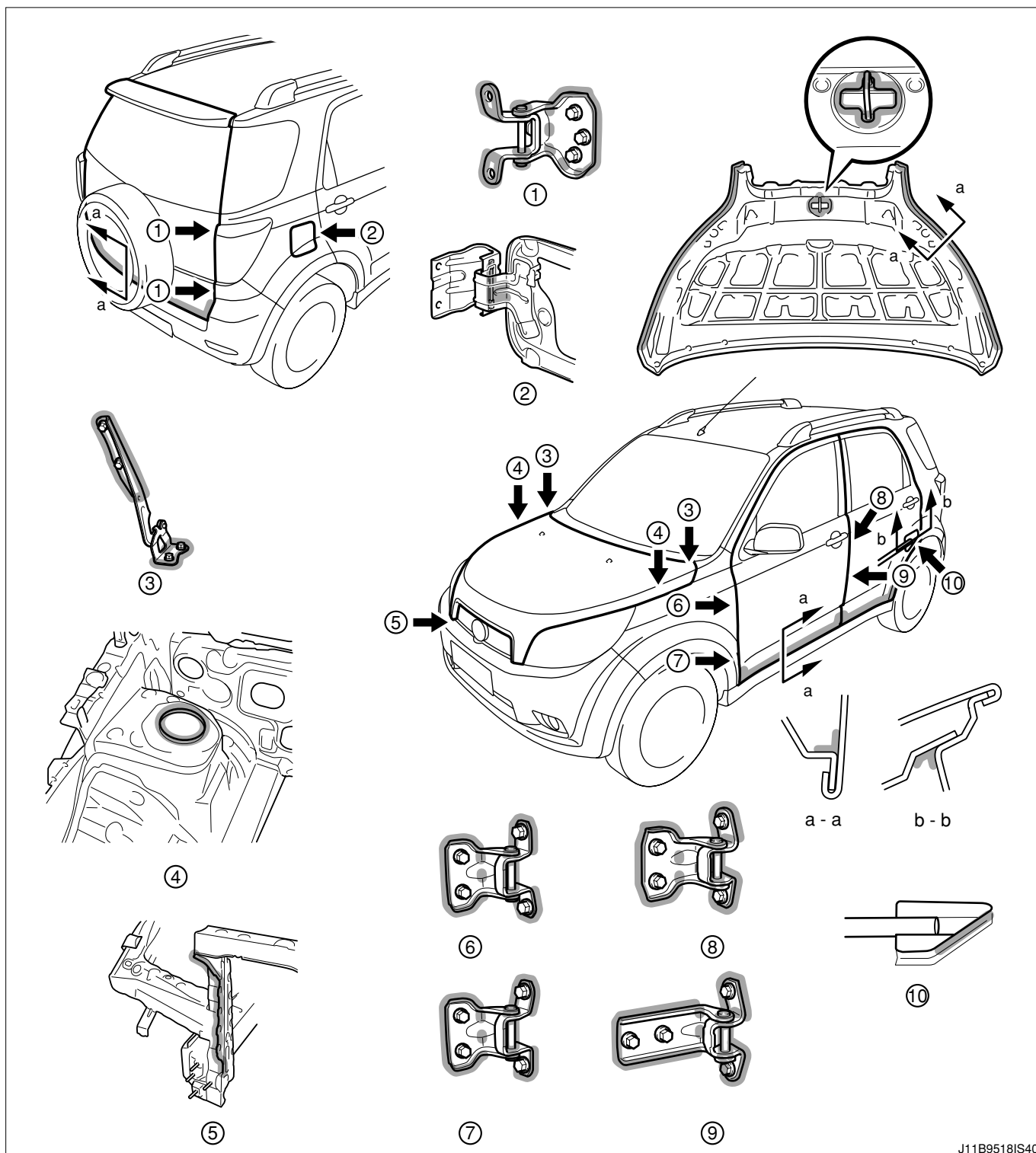

4 ANTI-CHIPPING PAINT

4-1 APPLICATION

4-1-1 APPLICATION SECTION

Apply anti-chipping paint at the range shown in the figure.

Interlayer anti-chipping coating

