

VEHICLE IDENTIFICATION NUMBER, ENGINE SERIAL NUMBER AND TRANSMISSION SERIAL NUMBER

LOCATION

IN

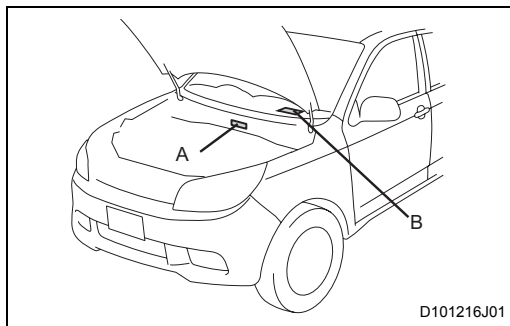

1. Vehicle Identification Number

- (a) The vehicle identification number is stamped on the vehicle body (labeled A in the illustration) and on the certification label (labeled B in the illustration).

A:

Vehicle Identification Number

B:

Certification Label

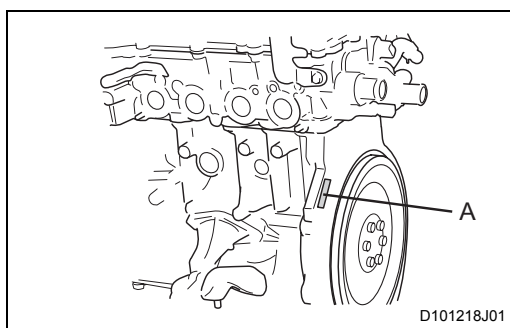

2. Engine Serial Number and Transmission Serial Number

- (a) The engine serial number is stamped on the cylinder block of the engine.

A:

3SZ, K3

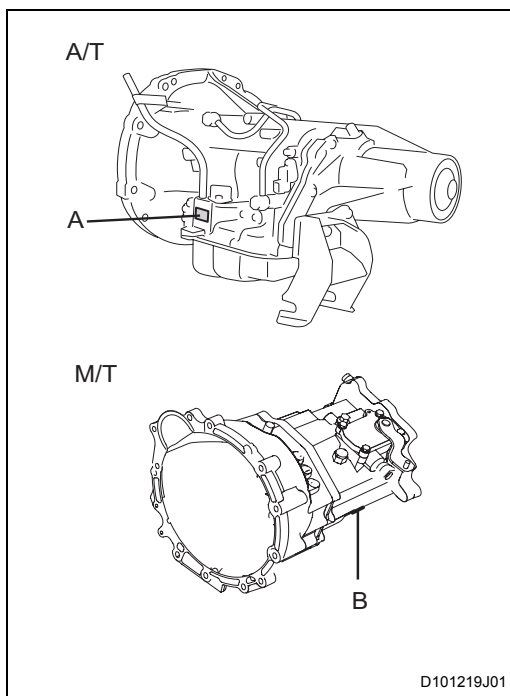

- (b) The transmission serial number is stamped on the certification label of the transmission case.

A:

A4Q-D1

B:

M5S

