

# THROTTLE BODY ASSEMBLY (3SZ-VE)

## COMPONENTS

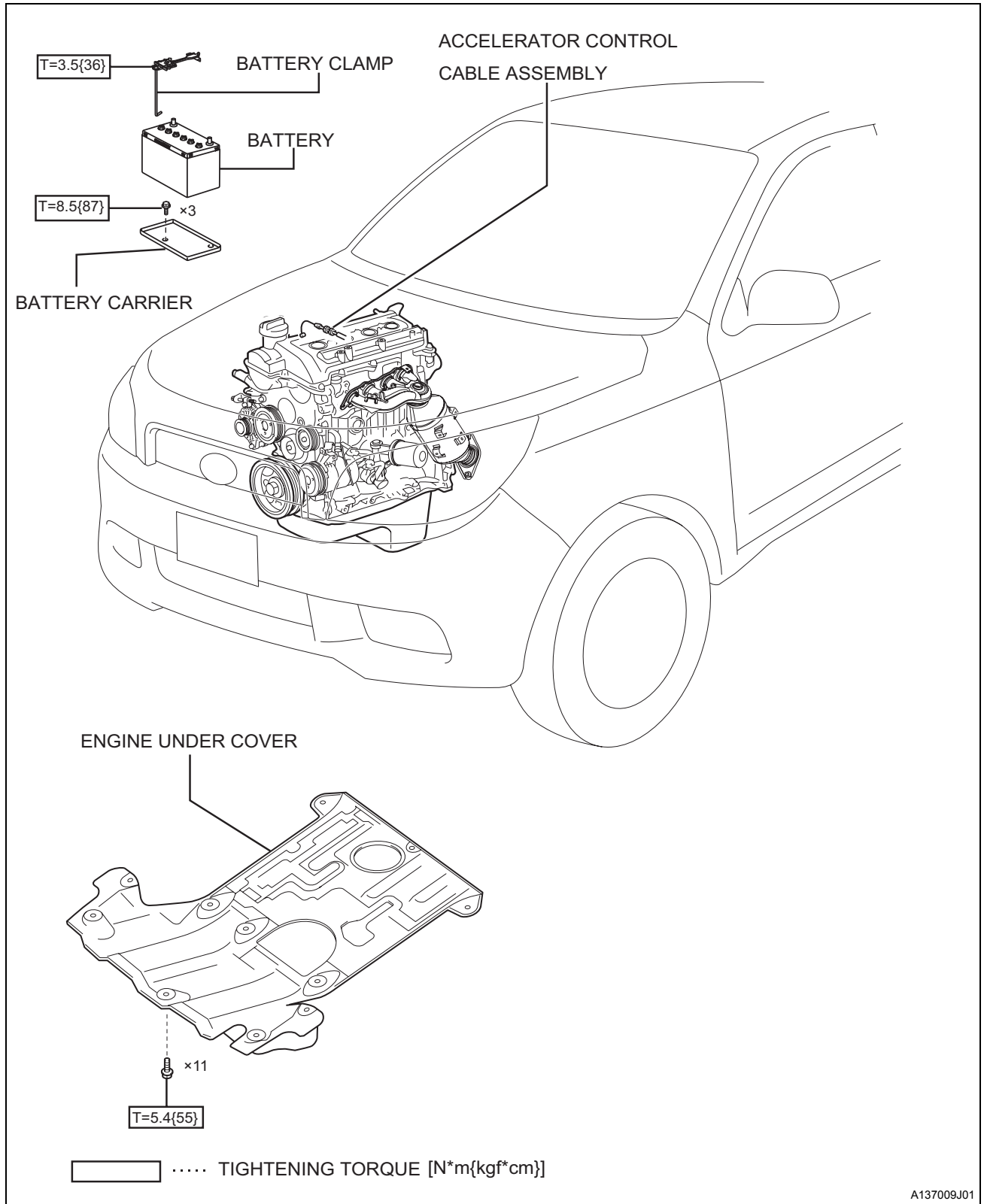

ES



ES

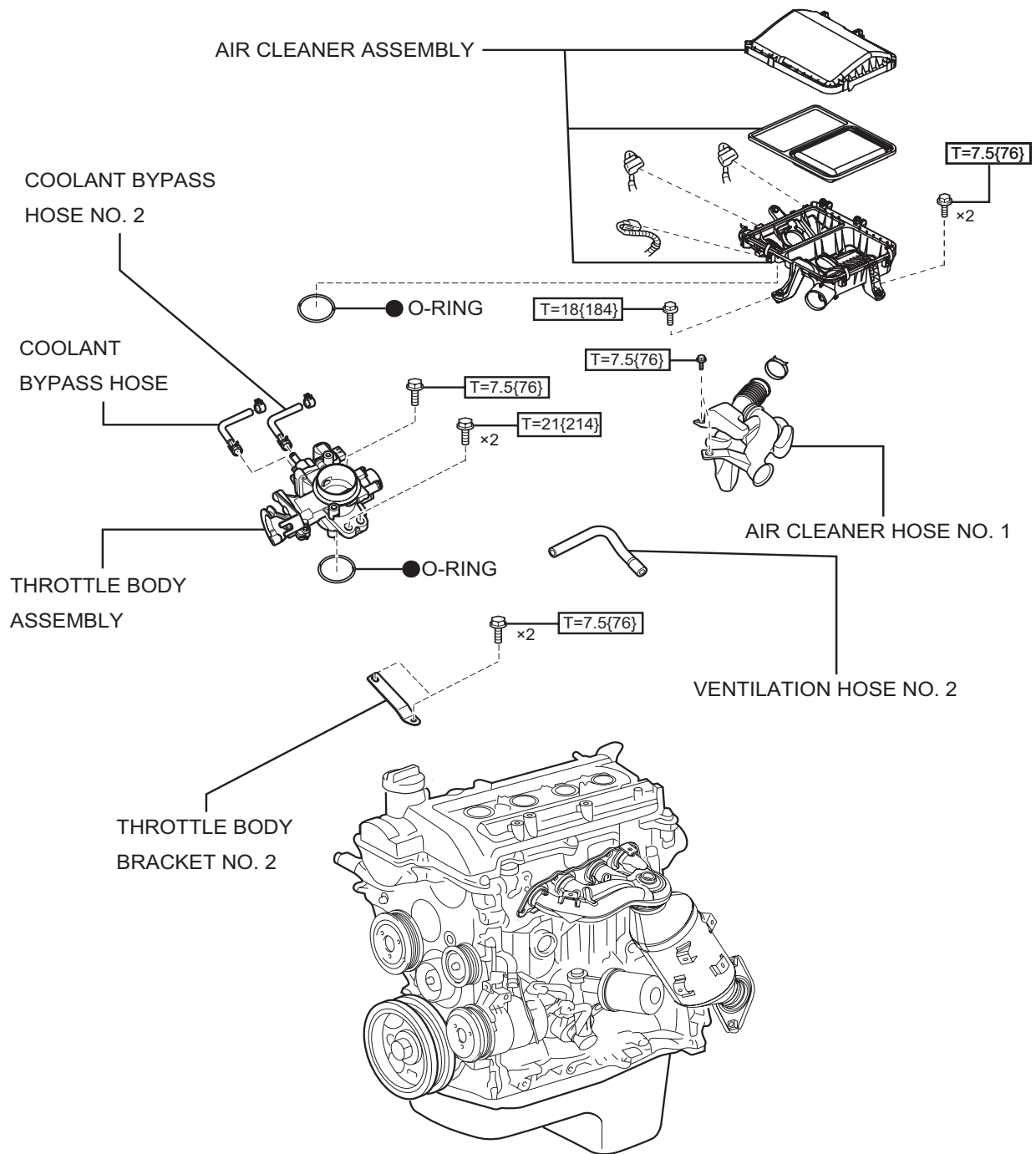

## REMOVAL

1. **DISCONNECT NEGATIVE BATTERY TERMINAL**  
(See page RS-164.)
2. **REMOVE ENGINE UNDER COVER**
3. **DRAIN ENGINE COOLANT** (See page CO-9)
4. **REMOVE AIR CLEANER HOSE NO.1** (See page CO-15)
5. **REMOVE AIR CLEANER ASSEMBLY** (See page EM-146)
6. **DISCONNECT ACCELERATOR CONTROL CABLE ASSEMBLY**  
(See page EM-147)
7. **REMOVE VENTILATION HOSE NO.2** (See page EM-147)
8. **DISCONNECT WATER BY-PASS HOSE**
  - (a) Disengage the clamps and disconnect the water by-pass hose.

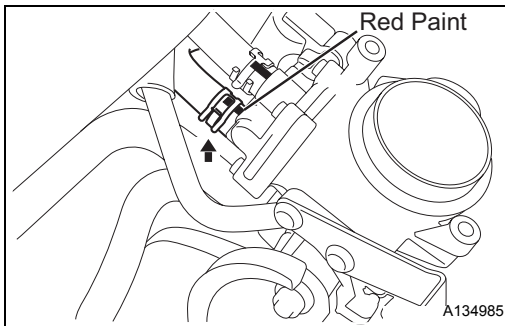
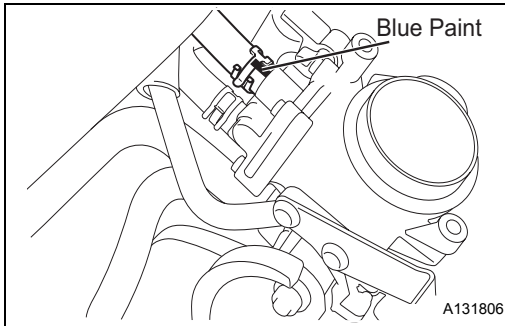
**ES**

9. **DISCONNECT WATER BY-PASS HOSE NO.2**
  - (a) Disengage the clamps and disconnect water by-pass hose No.2.

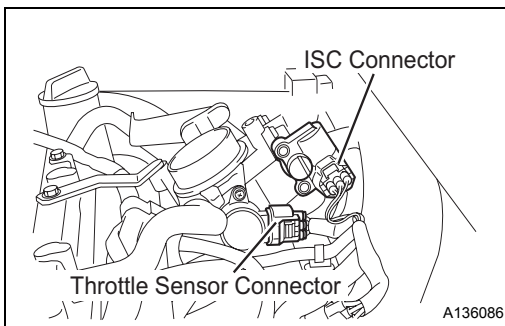

10. **REMOVE THROTTLE BODY ASSEMBLY**
  - (a) Disconnect the connector of the throttle body assembly and the wire harness clamps.

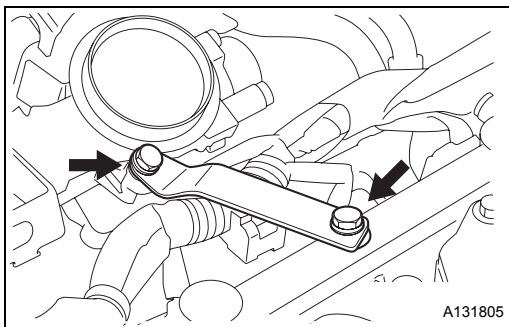

- (b) Remove the 2 bolts and throttle body bracket No.2.
- (c) Remove the 3 bolts and the throttle body assembly.
- (d) Remove the O-rings.

ES

## INSTALLATION

### 1. INSTALL THROTTLE BODY ASSEMBLY

- (a) Install a new O-ring.
- (b) Install the throttle body assembly with the 3 bolts.  
**Torque: 21 N\*m (214 kgf\*cm) Throttle body bracket side**  
**7.5 N\*m (77 kgf\*cm) Intake manifold side**
- (c) Install throttle body bracket No.2 with the 2 bolts.  
**Torque: 7.5 N\*m (76 kgf\*cm)**

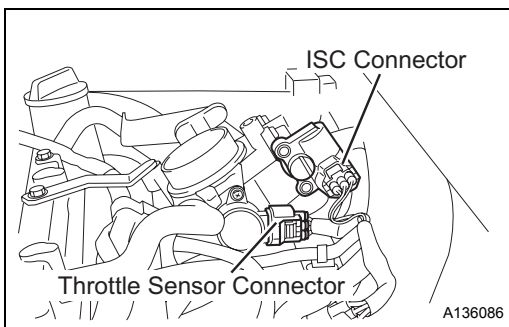
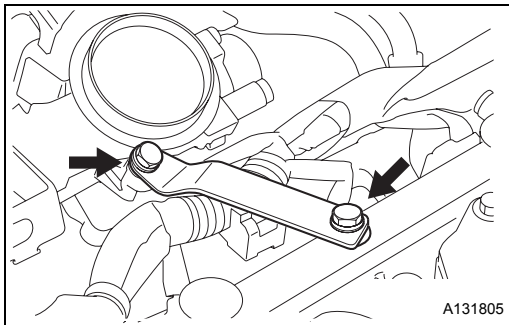

- (d) Connect the connectors to the throttle body assembly.

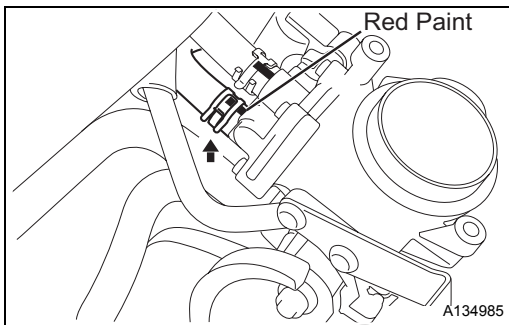

### 2. CONNECT WATER BY-PASS HOSE

- (a) Connect the water by-pass hose and install the clamp.

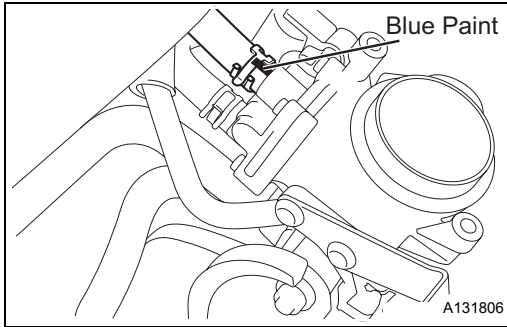

3. **CONNECT WATER BY-PASS HOSE NO.2**  
(a) Connect water by-pass hose No.2 and install the clamp.
4. **INSTALL VENTILATION HOSE NO.2** (See page EM-166)
5. **INSTALL ACCELERATOR CONTROL CABLE ASSEMBLY** (See page EM-165)
6. **INSTALL AIR CLEANER ASSEMBLY** (See page EM-167)
7. **INSTALL AIR CLEANER HOSE NO.1** (See page CO-19)
8. **ADD COOLANT** (See page CO-9)
9. **CHECK FOR COOLANT LEAKS** (See page CO-10)
10. **INSTALL ENGINE UNDER COVER** (See page EM-69)
11. **CONNECT NEGATIVE BATTERY TERMINAL**  
Torque: 5.4 N\*m (55 kgf\*cm)
12. **PERFORM INITIALIZATION**  
(See page SS-10.)

**ES**

## INSPECTION

1. **INSPECT THROTTLE BODY ASSEMBLY**
  - (a) Check that the throttle shaft is not loose.
  - (b) Check that none of the ports is clogged.
  - (c) Check that the throttle valve can open and close smoothly.
  - (d) Check that there is no clearance between the throttle stop screw and the lever when the throttle valve is fully open.

